



17/5-11 Samuel Terry Avenue Kensington, NSW



2



1



1

Quietly nestled at the rear of a character-filled Georgian-style building

Discover the perfect blend of classic charm and modern living in this inviting first-floor apartment, quietly nestled at the rear of a character-filled Georgian-style building. Set between Kensington Village and the vibrant Green Square town centre, this home offers a peaceful retreat with a beautiful outlook and plenty of natural light.

The apartment features high ceilings, lovely panelled windows, and a bright garden outlook that enhances its serene atmosphere. You'll appreciate the meticulously manicured gardens, reminiscent of an English manor, with expansive lawns perfect for relaxation. A sunny lawn area and secure undercover car spot within a lockable basement add to the appeal.

Inside, the apartment includes two spacious double bedrooms with built-in robes, a modern gas kitchen with a dishwasher, a neat and tidy bathroom, and laundry facilities. The grand entry leads you into a stylish terrazzo foyer, contributing to the overall charm and character of the home.

Located in a tranquil, leafy avenue, you're just a 500m stroll to East Village marketplace, packed with shops, cafes, a...

Price: SOLD | Time Realty
Council Rates: \$456.00 p/q
Water Rates: \$180.00 p/q
Strata Rates: \$1,615.58 p/q

Adam Scappatura **Frank Settineri**

0413 355 481

0414 889 319

PLANS SHOWN ONLY INDICATIVE OF LAYOUT. DIMENSIONS ARE APPROXIMATE.

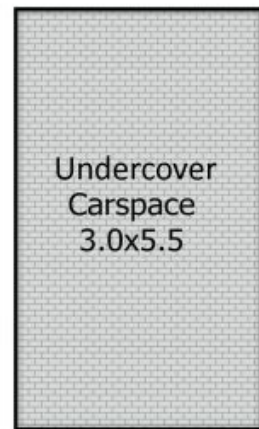
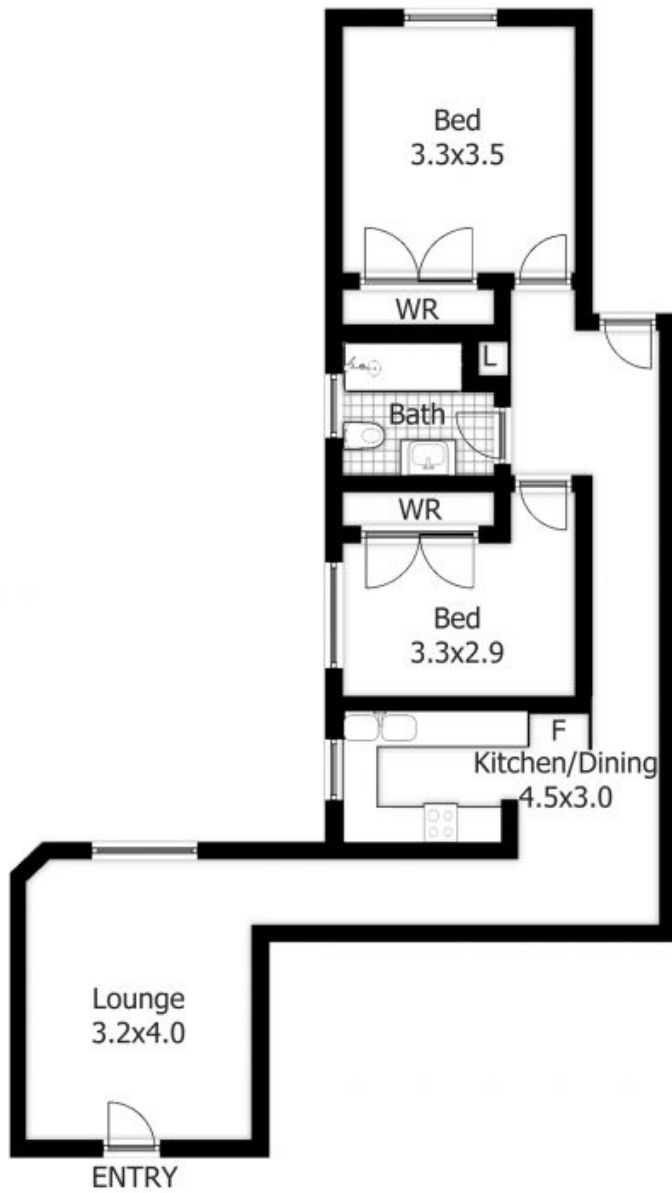

(NOT IN POSITION)



17/5-11 Samuel Terry Ave
KENSINGTON

EST — 1979
time