



19/173 Bronte Road Queens Park, NSW



1



1



1

Sophisticated 1 Bedroom Apartment In Prime Location

Quietly set within a modern security complex with beautiful gardens, this stylish & generously proportioned apartment is moments from Queens Park & Charing Cross village and a short walk to Bondi Junction. With easy lift access it features a spacious living & dining area with polished timber floors. The generous layout also includes a big main bedroom, sleek modern bathroom, designer Caesarstone gas kitchen and concealed laundry.

Features Include:

- Freshly polished timber flooring
- Secure contemporary building designed around a central landscaped garden
- Level lift access from the street and secure undercover parking
- On-site cafe/diner
- Freshly painted throughout.
- Footsteps to Charing Cross village boutiques and eateries
- A 200m stroll to Queens Park with convenient rear access via Taylor Street and a level 600m to Westfield's premier shopping and entertainment precinct.
- Kitchen Island Bench NOT included

Price: \$750 pw

Available Date: 2023-07-11

Emanuel Koumis **Costa Athanassiou**

0402 644 121

9712 1188

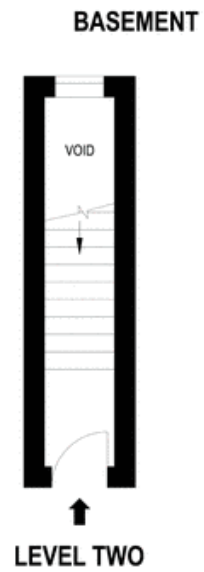
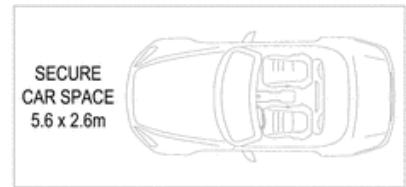

APPROX.INT: 55m²
APPROX.EXT: 24m²



Scale in metres. Indicative only. Dimensions are approximate. All information contained herein is gathered from sources we believe to be reliable. However we cannot guarantee its accuracy and interested persons should rely on their own enquiries.

19/173-179 Bronte Road, Queens Park