



12 Fairwater Drive Breakfast Point, NSW



6



3



2

## A superb showcase of light, style and space

This is Breakfast Point family living at its very best with a spacious domain featuring impressive proportions, light-filled living spaces and relaxed outdoor entertainment zones. Nestled onto an easy maintenance level block in a quiet street position, it offers a wonderfully private retreat with a quality design that provides a fantastic place for indoor-outdoor living.

This full double brick home is very well-appointed throughout with cool marble flooring, lovely high ceilings and is perfectly orientated to capture great natural light. The interior layout caters to a modern family lifestyle and features multiple living areas with lots of flexibility for homeowners. There are five great-sized bedrooms, a stylish modern kitchen with breakfast bar and gas cooking, plus an extra home office for work-from-homers.

The inside connects seamlessly with the outdoors for an easy entertainer's lifestyle complete with a large covered deck and level house garden, along with an eight-person hot tub and BBQ area. The property also features a double lock-up garage plus storage shed and air-conditionion...

- Well-proportioned rooms with bright living spaces on both levels
- Fully equipped home theatre with projector and surround sound
- Marble floored interiors feature a large open plan casual space
- Large deck and low-maintenance garden with a north rear aspect
- Five spacious bedrooms with built-ins plus a separate study/office
- A quality modern kitchen, three bathrooms and internal laundry
- Air-conditioning, security alarm and excellent storage throughout
- Automatic two-car garage with storage space and internal access

Co-agent Dib Chidiac 0415 657 331

**Price:** SOLD | Time Realty  
**Council Rates:** \$499.00 p/q  
**Water Rates:** \$161.00 p/q  
**Strata Rates:** \$466.60 p/q

**Lambros Markessinos Adam Scappatura**

0407 788 777

0413 355 481

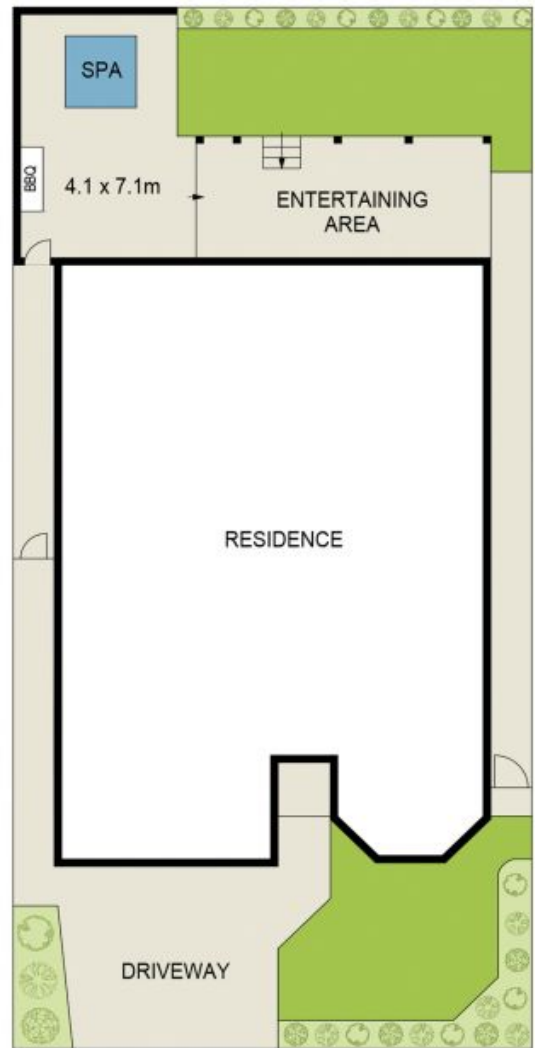

PLANS SHOWN ONLY INDICATIVE OF LAYOUT. DIMENSIONS ARE APPROXIMATE.



12 Fairwater Drive  
**BREAKFAST POINT**

EST — 1979  
**time**