



5/9 Albert Road Croydon Park, NSW



Light Filled With Park Views

Ideally located at the front of a small security block of only 6 apartments with pleasant leafy views directly across from the park, this spacious 2-bedroom apartment will make the perfect first home or investment.

Offering fresh interiors with open plan living spaces, updated eat in kitchen, modern bathroom, internal laundry and large balcony with gorgeous park views.

The convenience and comfort of your own car space just adds to the appeal of this desirable apartment.

Situated only a short walk to Campsie train Station with all amenities including parks, cafes as well as Burwood and Campsie shopping villages nearby, this property is definitely one worth inspecting.

- Freshly painted light filled apartment with park views
- Updated kitchen & renovated bathroom, open plan living
- Small security building, built-in wardrobe in main bed
- Large balcony, private car space and internal laundry
- Short walk to Campsie Train Station and all amenities

Price: SOLD | Time Realty
Council Rates: \$330.00 p/q
Water Rates: \$154.00 p/q
Strata Rates: \$1,250.05 p/q

Adam Scappatura Frank Settineri

0413 355 481

0414 889 319

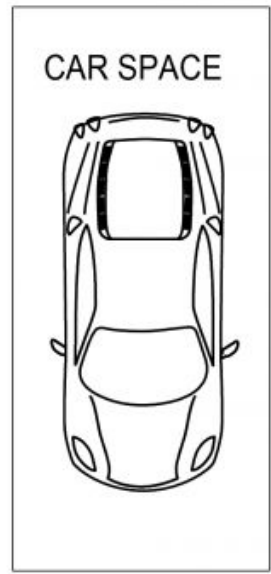
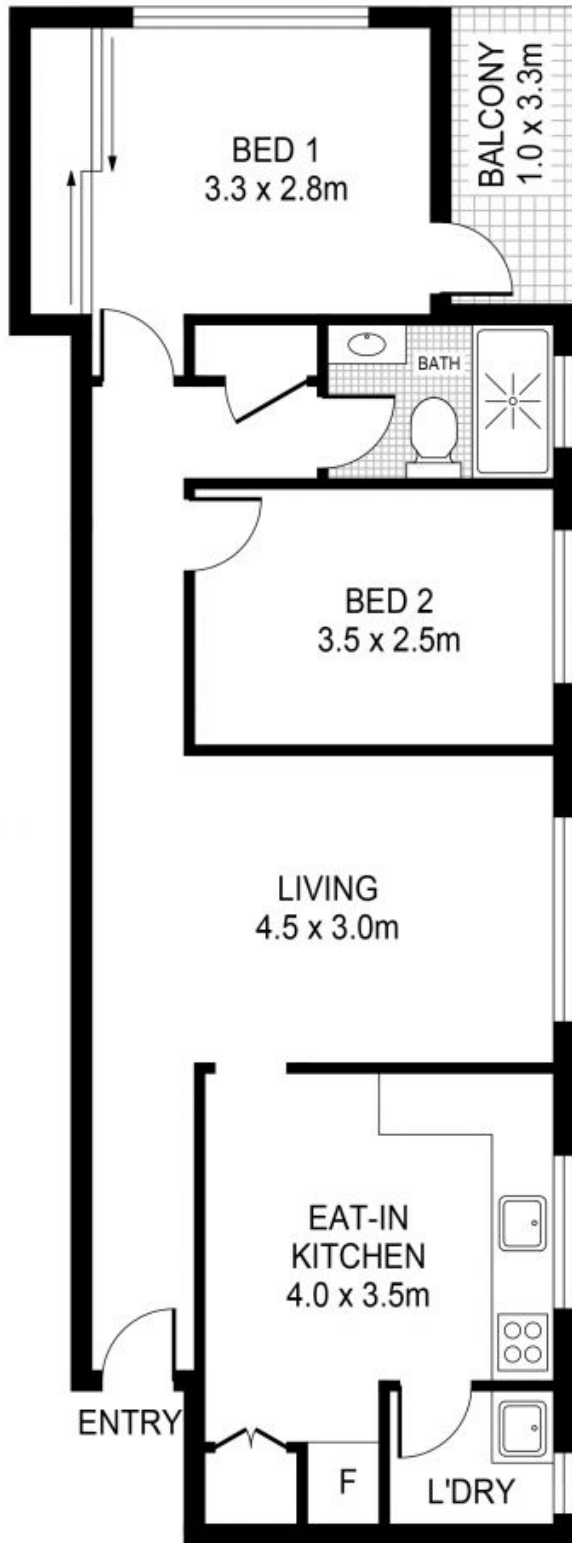

PLANS SHOWN ONLY INDICATIVE OF LAYOUT. DIMENSIONS ARE APPROXIMATE.



5/9 albert Road
CROYDON PARK

EST — 1979
time