



225/1 Missenden Road Camperdown, NSW



Whisper quiet one bedroom apartment

Quietly set at the rear of Rhodes House, this amazing apartment offers the ultimate lifestyle. Super spacious in an ideal City-fringe location, close to both Newtown and Annandale cafes and only steps to fast CBD bus transport.

Features of this great apartment include spacious gourmet kitchen and a large living/dining area which leads to a sizeable balcony with a great outlook.

Enjoy the convenience of ample storage within the apartment and spacious bathroom with internal laundry.

Rhodes House offers great resort style facilities including roof-top terrace with amazing views, tennis court, gym, swimming pool and additional relaxation spaces to soak up the sun and enjoy the panoramic views.

With the superb convenience of express city buses, RPA Hospital, shops and local cafes all just footsteps from the front door, plus the bonus of the ever-vibrant King Street with an array of restaurants and cuisines to tantalise your taste buds just a stroll away.

Don't delay book your inspection today!

- Conveniently located serene 1 bedroom apartment
- Spacious living/dining areas opens out to balcony
- Gourmet kitchen, large benchtop and dishwasher
- Resort style facilities & access to roof top terrace
- Close to city buses, shops, cafes and restaurants

Price: SOLD | Time Realty
Council Rates: \$286.00 p/q
Water Rates: \$158.00 p/q
Strata Rates: \$2,150.71 p/q

Adam Scappatura **Frank Settineri**

0413 355 481

0414 889 319

PLANS SHOWN ONLY INDICATIVE OF LAYOUT. DIMENSIONS ARE APPROXIMATE.

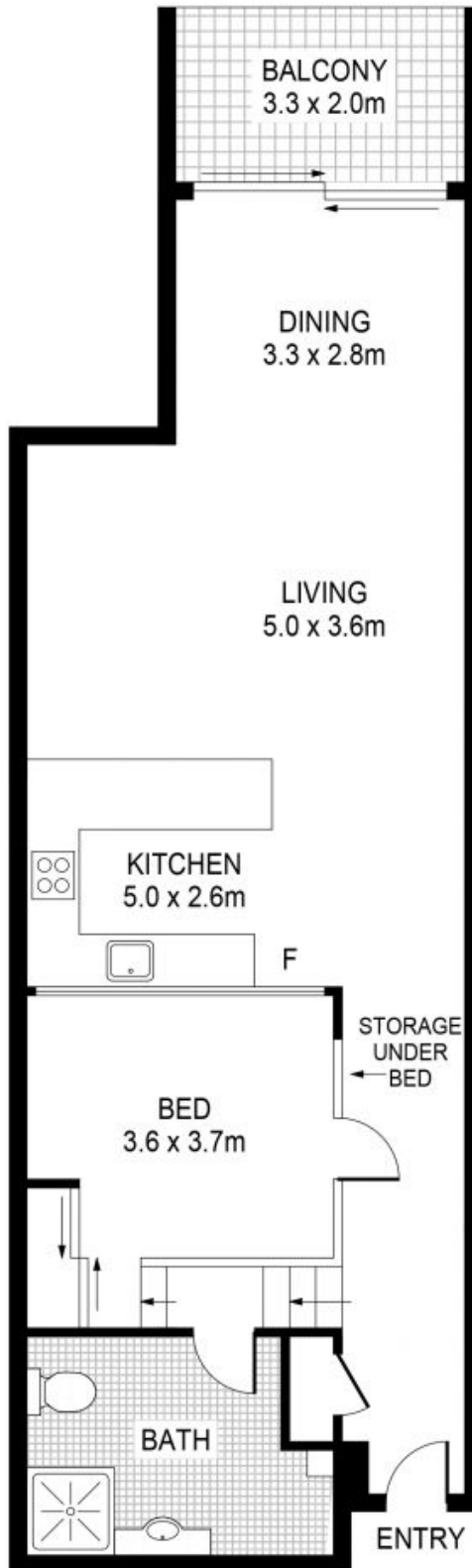

225/1 Missenden Road
CAMPERDOWN

EST — 1979
time