



2 Heath Street Concord, NSW



3



1



2

## SOLD Prior to AUCTION - Location and Potential

Be amazed by the potential of this home in one of Concord's sort after streets, offering a rare two street frontage. This comfortable 3 bedroom home sit on 442 sqm and offers so many possibilities with the option to move in, renovate or knock down and rebuilt (STCA). With its original but immaculate kitchen and bathroom, separate lounge and dining area lock up garage and its sizeable yard with two drive ways. The home sits in an elevated position and enjoys views across Howse Park. Ideally located within minutes to all conveniences such as transport, all day bus service to the city, water front, parkland & Majors Bay Village. Be quick to inspect this home today.

**Price:** SOLD - \$1,300,000  
**Council Rates:** \$331.00 p/q  
**Water Rates:** \$177.00 p/q

- Spacious 3 bed home with a land size of 442 sqm (approx)
- Original kitchen & bathroom, separate lounge & dining area
- Good sized backyard, two driveways with 2 street frontage
- Move in and enjoy, renovate or build your dream home
- Located close to transport, shops, parkland and the Bay

**Adam Scappatura** **Frank Settineri**

0413 355 481

0414 889 319

# 2 Heath St, CONCORD

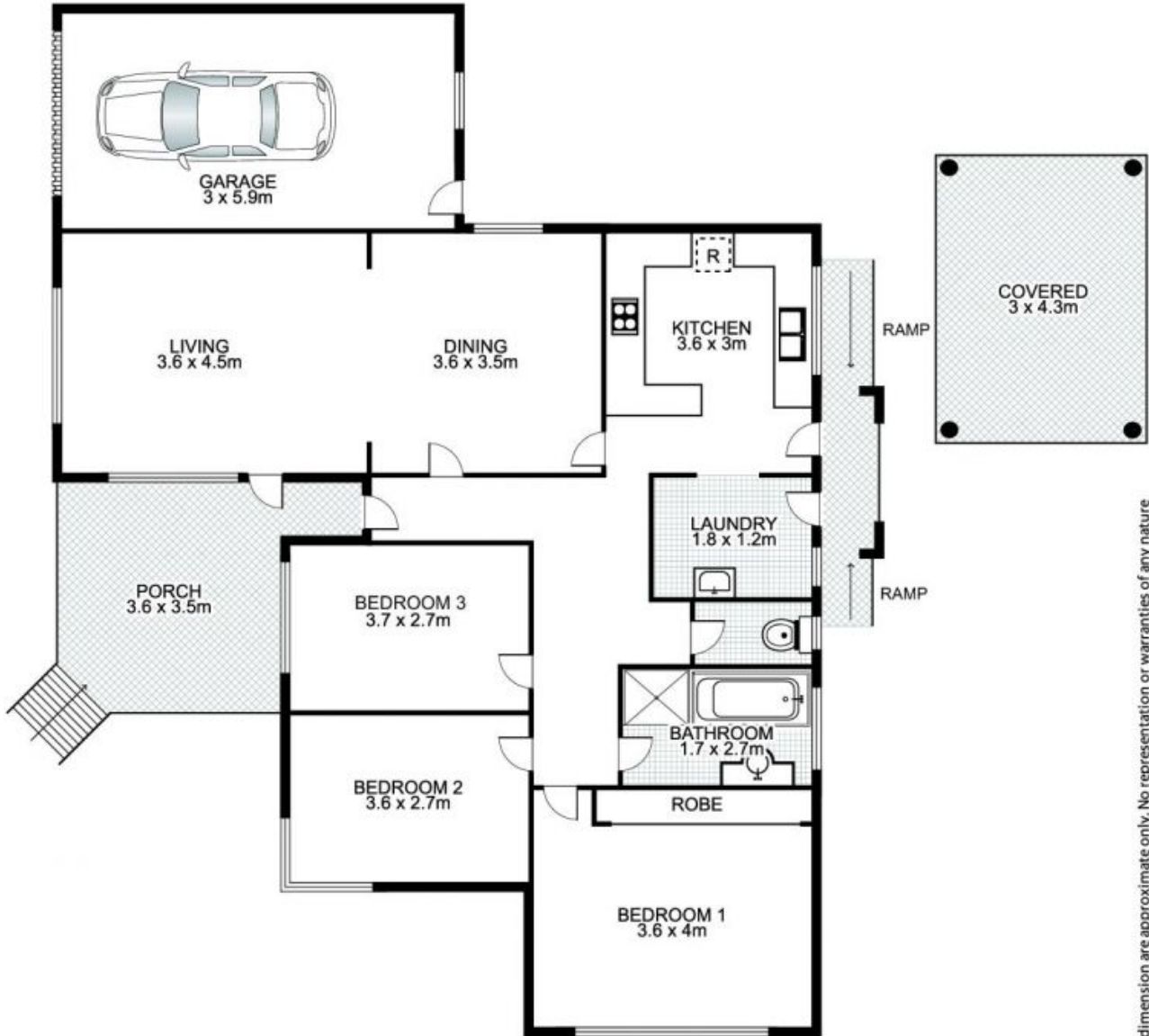

**NORTH**

Plans by  
**surroundpix**  
com.au  
1300 30 32 40

This floor plan is intended as a guide only. Layout dimensions are approximate only. No representation or warranties of any nature whatsoever are given or intended. Any person using this information should rely on their own enquiries.