



1/16 Wrights Road Drummoyne, NSW



3



2



2

## SOLD - Quality Family Living ~ Entertainers' Courtyard ~ No Common walls

Free standing, three bedroom Townhouse with no common walls, two car lock up garages are rare, especially when they are in a small "boutique complex" of only 5.

This quality home is situated within close proximity to local schools, cafes', restaurants and waterfront park lands. Being able to walk to City and suburban buses plus the River cat presents added value.

For all your shopping needs Top Drummoyne or Birkenhead Point are within walking distance. Rozelle, Balmain, Five Dock and Burwood shopping centres are also close by.

Bright and well-presented throughout features include, polished timber floor boards, high ceilings and a huge private and leafy entertainers' courtyard.

All three double bedrooms have built-ins, the main bedroom also has an en suite. Generous lounge and dining give easy access to the entertainers' courtyard through glass sliding doors. There's a gas, stainless steel timber kitchen with granite bench tops, a dishwasher and a breakfast bar. Includes a downstairs powder room, an internal laundry plus storage. A security double lock up garage completes the picture.

- Freestanding three bedroom residence, security two car lock up garage
- Huge, private & leafy entertainer's courtyard, open plan lounge & dining
- Gas stainless steel timber kitchen, granite bench tops plus dishwasher
- Polished timber floors, powder room, en suite, internal laundry, storage
- Don't hesitate at the opportunity to give yourself the lifestyle you deserve!

**Price:** SOLD  
**Council Rates:** \$262.00 p/q  
**Water Rates:** \$178.00 p/q  
**Strata Rates:** \$1,231.00 p/q

**Jim Piper**

0417 018 161

**Time Realty**

9712 1188



GROUND FLOOR

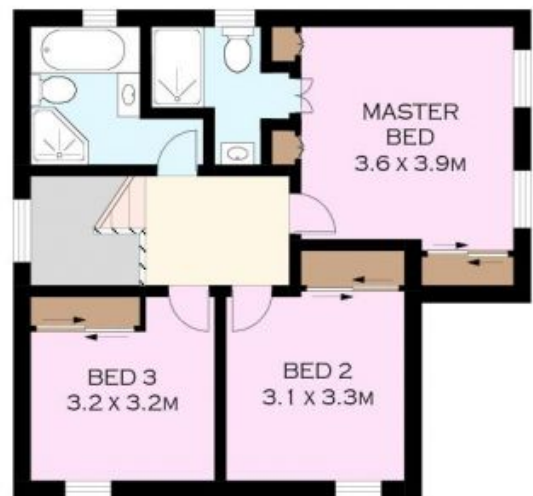

FIRST FLOOR



PLANS SHOWN ONLY INDICATIVE OF LAYOUT. DIMENSIONS ARE APPROXIMATE.  
Floor plans by [www.remaustralia.com](http://www.remaustralia.com)  
Ref. No: 11248

NOTE :- DOUBLE LOCK-UP GARAGE



1/16 WRIGHTS ROAD

DRUMMOYNE