



4/1 Gow Street Abbotsford, NSW



2



1



1

## SOLD - Peaceful and Leafy Water Views

With views from every room it is easy to see why only one owner has enjoyed the wonderful lifestyle which is on offer from this ideally located 2 bedroom townhouse with a lock up garage in a well maintained complex. Featured is a 42sqm approx, entertainer's courtyard with lovely leafy water views across Hen and Chicken Bay.

The home is situated within close proximity to local schools, cafes', restaurants and waterfront parklands. Being able to walk to City buses, the River cat and the ever popular Sydney Rowing Club presents added value. Also a leisurely stroll takes you to either Abbotsford or Wareemba Village shops. Nearby shopping centres are located in Five Dock, Drummoyne, Birkenhead Point and Burwood.

Combined lounge and dining leads through glass doors to a generous 42sqm approx, paved entertainer's courtyard. Here you can enjoy the sunny aspect and stunning sunsets across Hen and Chicken Bay. Upstairs both bedrooms are double in size, have terrace access and feature peaceful leafy water views. The kitchen has a servery/breakfast bar, there's a tidy bathroom, a separate WC, a p...

**Price:** SOLD  
**Council Rates:** \$201.00 p/q  
**Water Rates:** \$203.00 p/q  
**Strata Rates:** \$1,105.00 p/q

- Double bedrooms, built-in in main, terrace access, water views
- 42sqm approx. entertainer's courtyard with leafy water views
- Combined lounge and dining, glass doors open to the courtyard
- Kitchen with breakfast bar, tidy bathroom, 2 WC's, internal laundry
- This is a wonderful opportunity for astute owner occupiers or investors

**Jim Piper**

0417 018 161

**Time Realty**

9712 1188

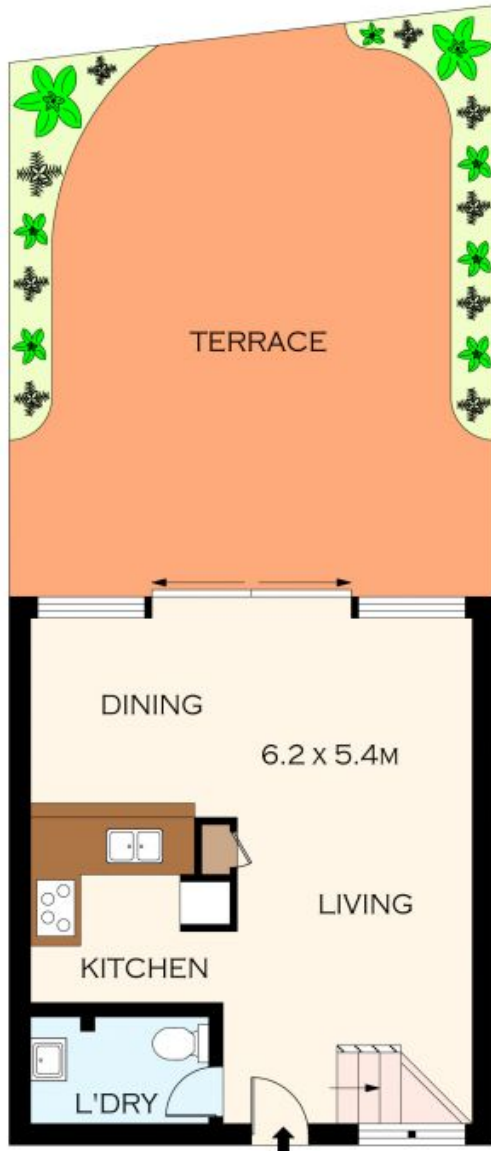

GROUND FLOOR

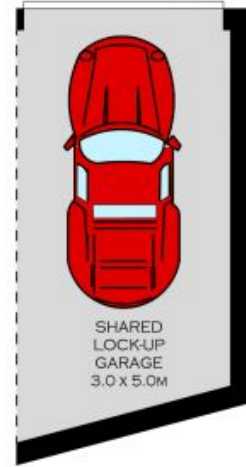

FIRST FLOOR



PLANS SHOWN ONLY INDICATIVE OF LAYOUT. DIMENSIONS ARE APPROXIMATE.  
Floor plans by [www.remaustralia.com](http://www.remaustralia.com)  
Ref. No: 11073



4/1 GOW STREET

ABBOTSFORD