



14/48 Edwin Street Mortlake, NSW



4



3



2

SOLD - Tri-level garden residence in waterside community

Space, light and quality come together in this three-level townhouse to provide a generous modern home tucked away in a sought-after bayside setting within footsteps to the water's edge. Set in the Kingfisher Cove complex, the light filled residence delivers a great low maintenance property with fresh interiors, good proportions and a choice of outdoor areas for entertaining.

Inside is a light and airy open design with polished timber floors and large fold-out doors that open seamlessly to the outside area. A paved rear courtyard makes a great place to relax and entertain, plus there is a separate grassed garden at the rear. The kitchen is smart and modern with its stone benchtops, sleek gas fittings and dishwasher, plus there are four double bedrooms with built-in wardrobes, including a large upper level master that has a walk-in robe, ensuite and access to a spacious roof terrace that captures leafy views over the surrounding area.

The home is fully air-conditioned and comes complete with its own double lock-up garage and direct private access via the garden. It is great for owne...

- Immaculate tri-level townhouse in an exclusive waterside position
- Paved entertainment courtyard plus private grassed garden
- Light filled open plan living space that flows to the outdoors
- Upper level roof terrace capturing elevated leafy outlooks
- Upper level master suite with walk-in robe and ensuite
- Ducted air-conditioning plus a double lock-up garage
- Walk to the ferry, shops, cafes and Yaralla Bay foreshore

Price: SOLD By Lambros Markessinis
Council Rates: \$266.00 p/q
Water Rates: \$172.00 p/q

Lambros MarkessinTime Realty

0407 788 777

9712 1188



GROUND FLOOR

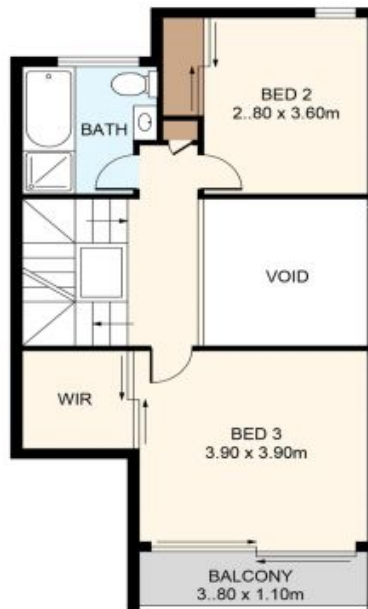

FIRST FLOOR

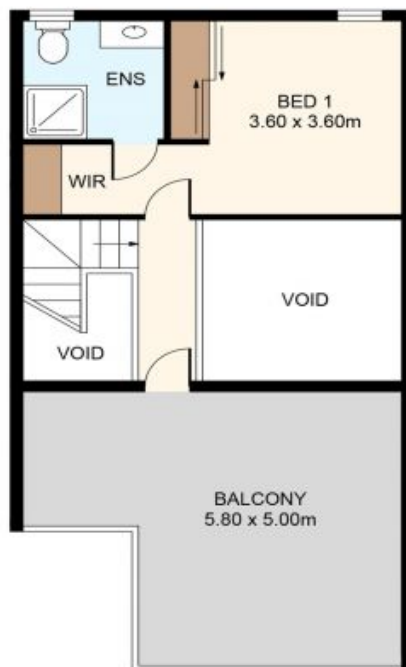

SECOND FLOOR

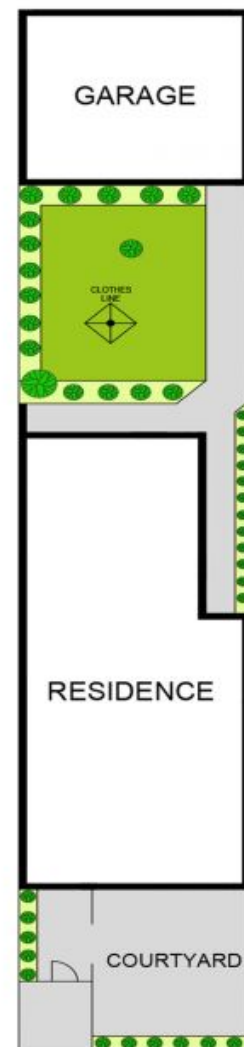
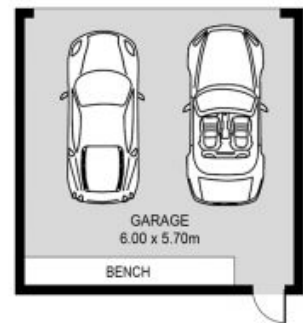

SITE PLAN
(NOT TO SCALE)

14/48 Edwin St
MORTLAKE

PLANS SHOWN ONLY INDICATIVE OF LAYOUT. DIMENSIONS ARE APPROXIMATE.

EST. 1979
time